

I'm excited you decided to make my Eiffel Tower Piñata! Please send me pictures to feature on my blog and Facebook page!!

To use this pattern just print all the pages - cardstock is best - with NO PAGE SCALING and overlap the pages by 1/4 inch. Tape them together to get the Eiffel tower shape at left.

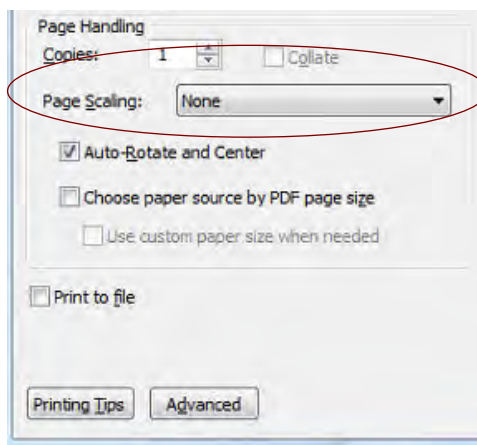

Once taped, cut the shape of the Eiffel Tower and trace it on 4 pieces of cardboard.

Go to the blog for the rest of the instructions!

Have fun!

Nathalie
www.pressprintparty.com

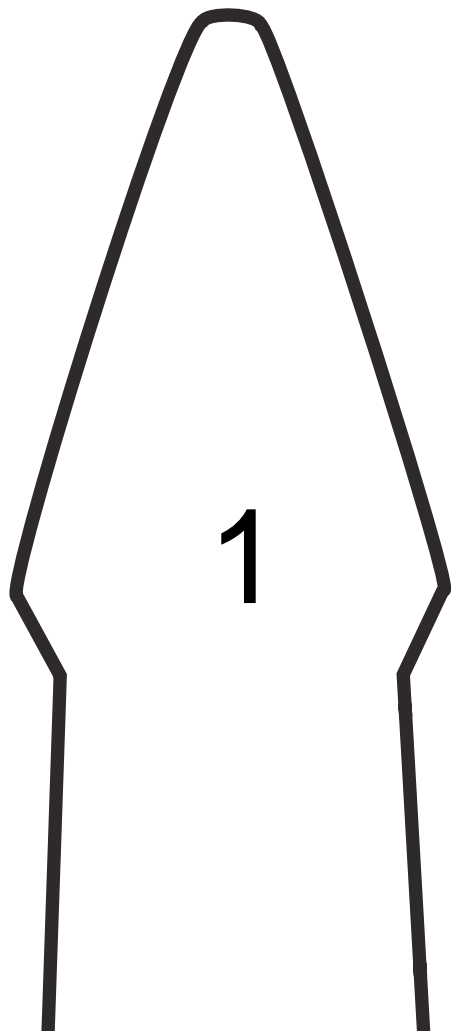



2

A large, faint, light gray number '3' is centered on the page, serving as a background watermark. The number is composed of two main vertical strokes that curve slightly inward at the top and bottom, connected by a horizontal bar in the middle. The overall appearance is that of a stylized, thin-lined numeral.

3

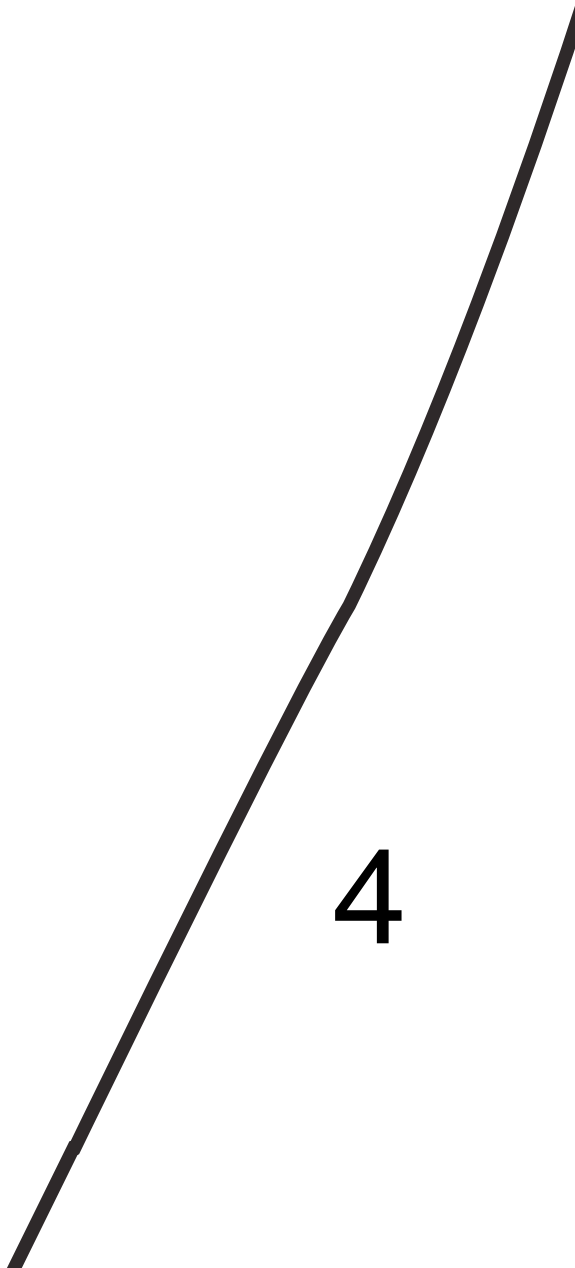

4



5

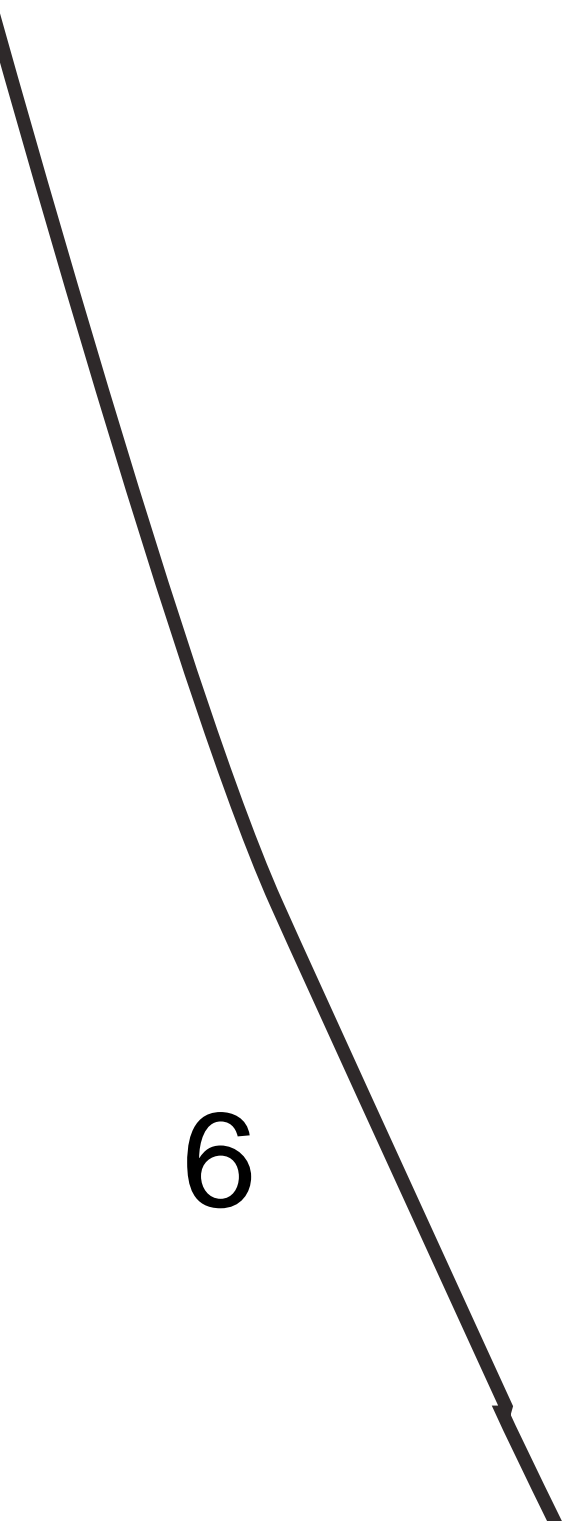

6

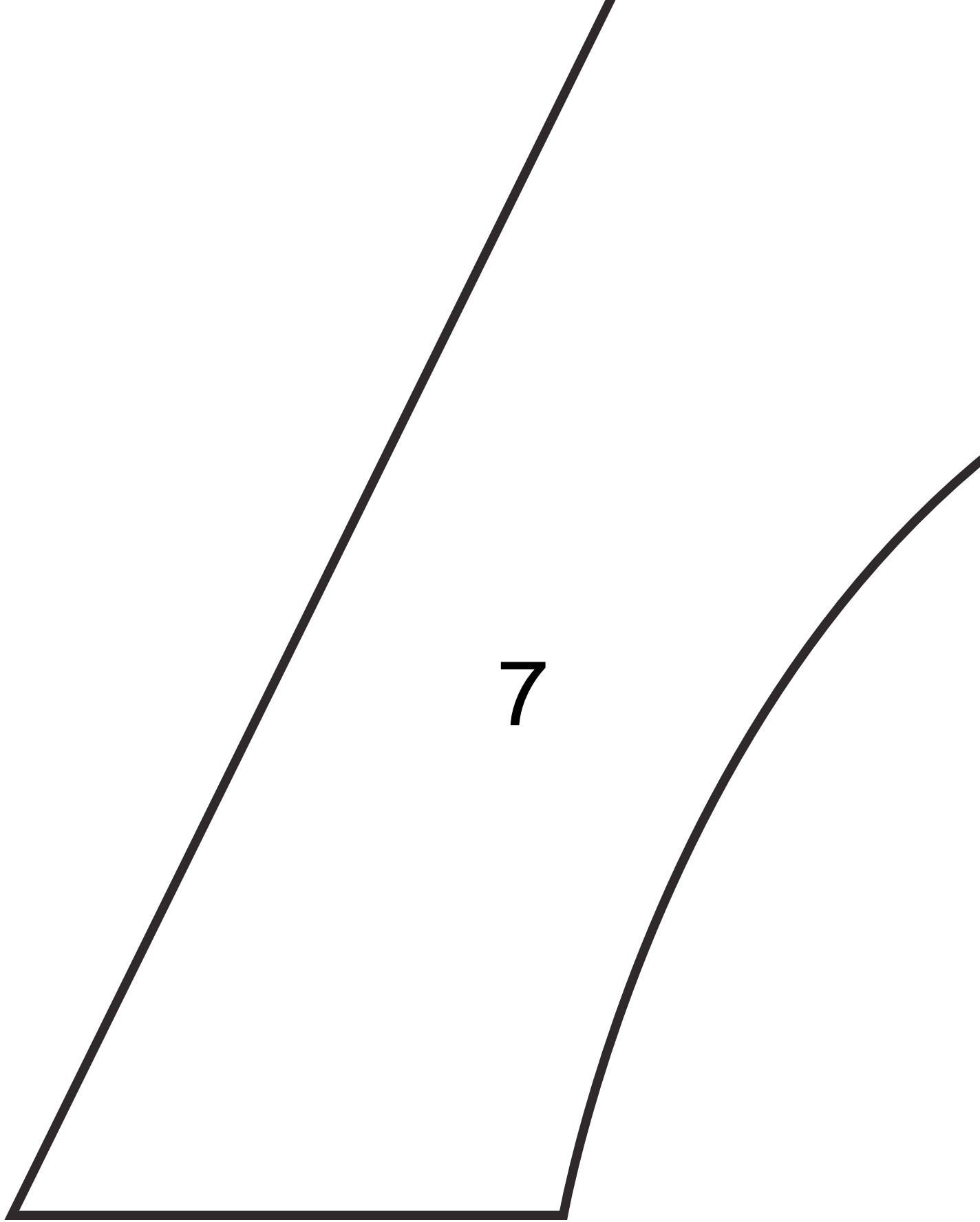

7

8



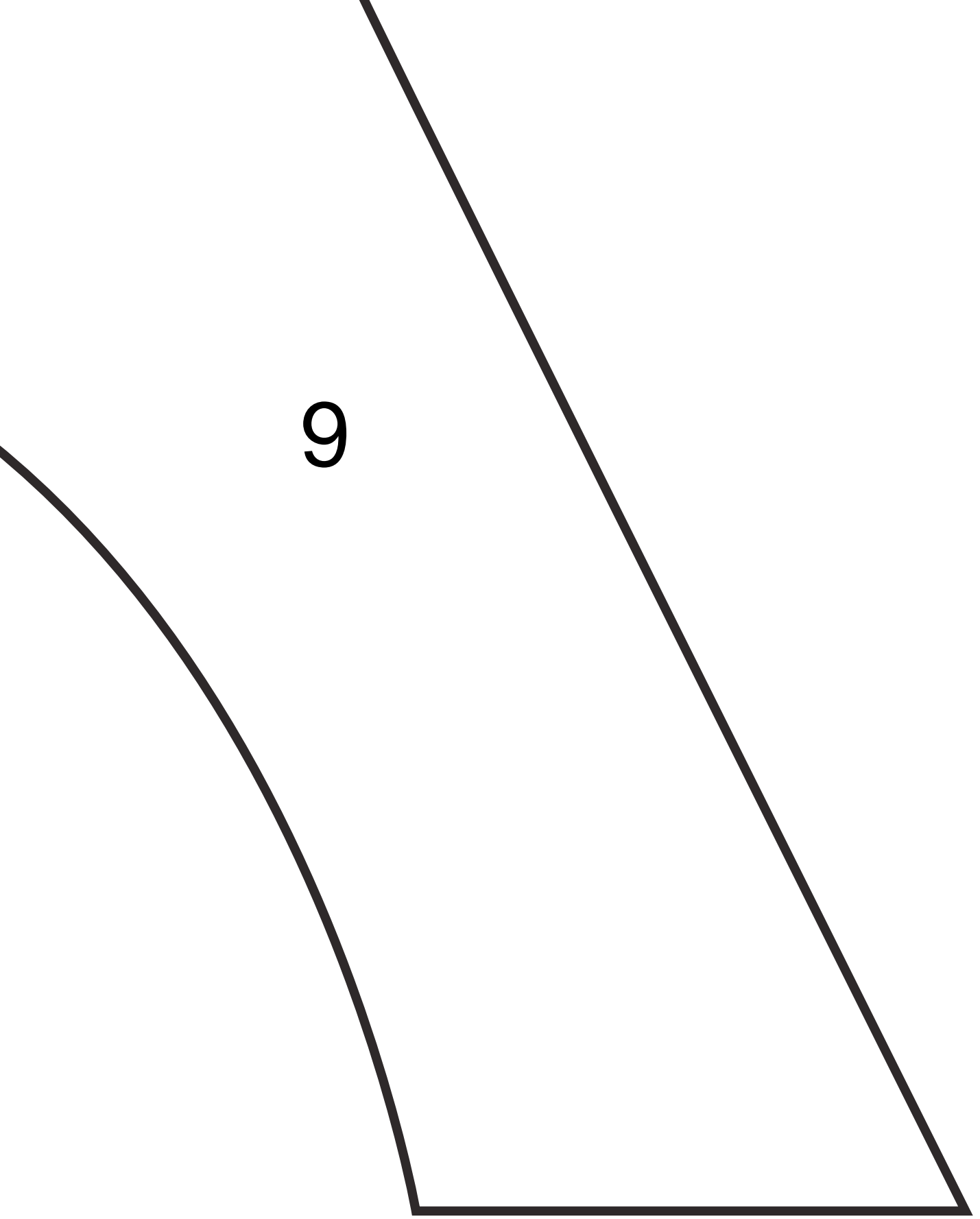

9